

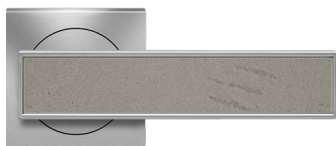

Torino

Finish: satin nickel (60) / Inlay concrete texture (KB1)

To suit standard 2 1/8" door prep



Torino- UR 53Q
2 5/8 x 2 5/8 x 7/16"

product code square

UR53Q PAS60 60 ...	passage 2 3/8" backset
UR53Q PAS70 60 ...	passage 2 3/4" backset
UR53Q PRI60 60 ...	privacy 2 3/8" backset
UR53Q PRI70 60 ...	privacy 2 3/4" backset
UR53Q DUM 60 ...	full dummy
UR53Q DUM L 60 ...	half dummy left
UR53Q DUM R 60 ...	half dummy right
UEDBQ 71...	deadbolt to add to passage



Torino- UR 53
Ø 2 5/8 x 7/16"

round

UR53 PAS60 60 ...	passage 2 3/8" backset
UR53 PAS70 60 ...	passage 2 3/4" backset
UR53 PRI60 60 ...	privacy 2 3/8" backset
UR53 PRI70 60 ...	privacy 2 3/4" backset
UR53 DUM 60 ...	full dummy
UR53 DUM L 60 ...	half dummy left
UR53 DUM R 60 ...	half dummy right
UEDB 71 ...	deadbolt to add to passage
UEDBA 71 ...	deadbolt keyed alike

Features UR53Q and UR53

- 3 piece rose
- concealed bolt-through fixing
- sprung
- door range 1 1/4" (31 mm) - 2" (51 mm) standard
- T- and Lip-Strike with dust box
- stainless steel faceplate
- backsets: 2 3/8" (60 mm) or 2 3/4" (70 mm)
- functions: Passage (PAS), Privacy (PRI), full dummy (DUM), dummy left (DUM L), dummy right (DUM R)
- available with UL-Latch
- 28° latch with attached face plate
- rate of satin stainless steel 304
- hub 5/16" (8 mm)
- door prep 2 1/8"
- available finish: satin nickel, chrome

laminate and carbon

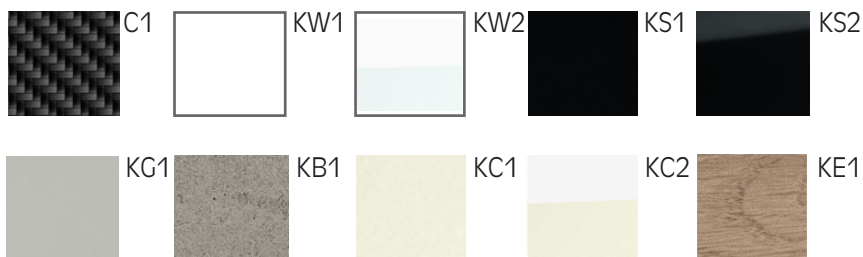

leather

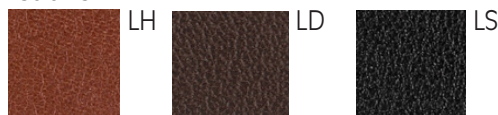

wood

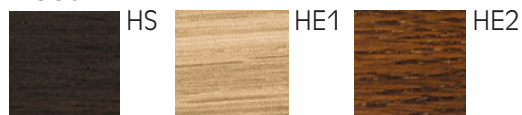

choose your inlay:

C1:	real carbon
KW1:	white
KW2:	shining white
KS1:	black
KS2:	shining black
KG1:	grey
KB1:	concrete texture
KC1:	cream white
KC2:	shining cream white
KE1:	light oak texture
LH:	light brown leather
LD:	dark brown leather
LS:	black leather
HS:	ebony
HE1:	light oak
HE2:	rustic oak

Inlays for model Torino UR53 to complete article code above (i.e. UR53Q PAS60 60 KE1)

specification details

lever

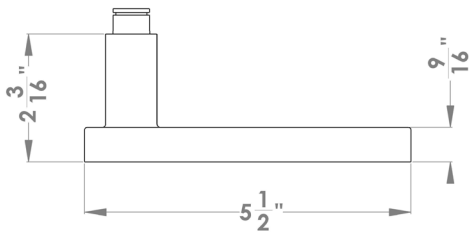

round rose

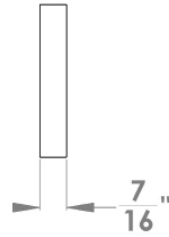
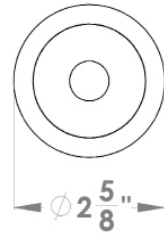

square rose

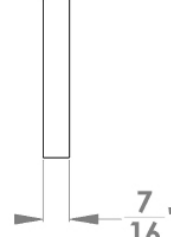
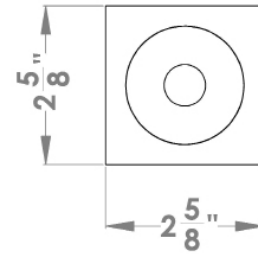

Please note: Karcher Design products are designed and measured in metric. Imperial measurements are close approximations to the actual metric dimensions

Tear Sheet
Model Torino on rose by KARCHER DESIGN

KARCHER
DESIGN

GERMANY

contact our US office
Karcher Design USA
Tukwila, Seattle
+1 844 858 2033
order@karcher-design.com

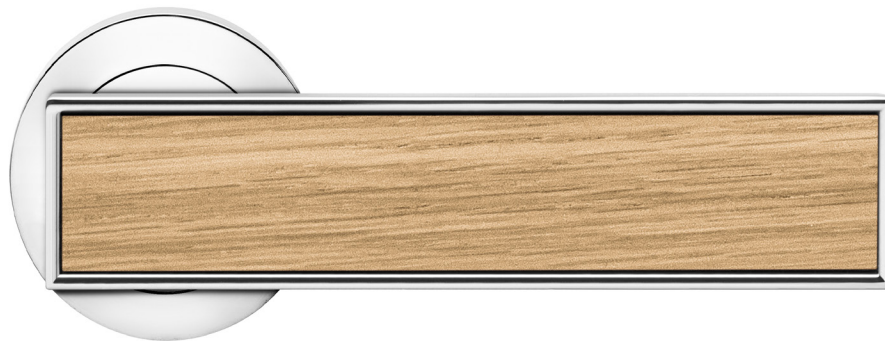

Torino

Finish: chrome (50) / inlay light oak (HE1)

To suit standard 2 1/8" door prep



Torino- UR 53Q
2 5/8 x 2 5/8 x 7/16"



Torino- UR 53
Ø 2 5/8 x 7/16"

product code square

UR53Q PAS60 50 ...	passage 2 3/8" backset
UR53Q PAS70 50 ...	passage 2 3/4" backset
UR53Q PRI60 50 ...	privacy 2 3/8" backset
UR53Q PRI70 50 ...	privacy 2 3/4" backset
UR53Q DUM 50 ...	full dummy
UR53Q DUM L 50 ...	half dummy left
UR53Q DUM R 50 ...	half dummy right
UEDBQ 72 ...	deadbolt to add to passage

round

UR53 PAS60 50 ...	passage 2 3/8" backset
UR53 PAS70 50 ...	passage 2 3/4" backset
UR53 PRI60 50 ...	privacy 2 3/8" backset
UR53 PRI70 50 ...	privacy 2 3/4" backset
UR53 DUM 50 ...	full dummy
UR53 DUM L 50 ...	half dummy left
UR53 DUM R 50 ...	half dummy right
UEDB 72 ...	deadbolt to add to passage
UEDBA 72...	deadbolt keyed alike

Features UR53Q and UR53

- 3 piece rose
- concealed bolt-through fixing
- sprung
- door range 1 1/4" (31 mm) - 2" (51 mm) standard
- T- and Lip-Strike with dust box
- stainless steel faceplate
- backsets: 2 3/8" (60 mm) or 2 3/4" (70 mm)
- functions: Passage (PAS), Privacy (PRI), full dummy (DUM), dummy left (DUM L), dummy right (DUM R)
- available with UL-Latch
- 28° latch with attached face plate
- rate of satin stainless steel 304
- hub 5/16" (8 mm)
- door prep 2 1/8"
- available finish: chrome, satin nickel

laminate and carbon

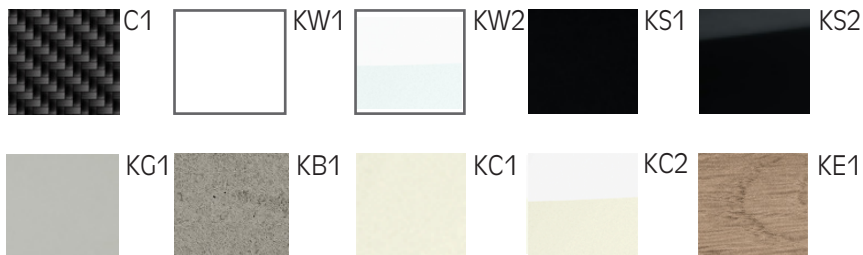

leather

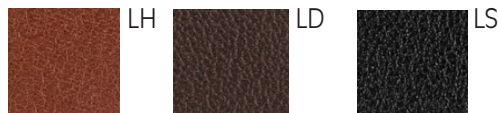

wood



choose your inlay:

C1: real carbon
KW1: white
KW2: shining white
KS1: black
KS2: shining black
KG1: grey
KB1: concrete texture
KC1: cream white
KC2: shining cream white
KE1: light oak texture

LH: light brown leather
LD: dark brown leather
LS: black leather

HS: ebony
HE1: light oak
HE2: rustic oak

Inlays for model Torino UR53 to complete article code above (i.e. UR53Q PAS60 50 KE1)

specification details

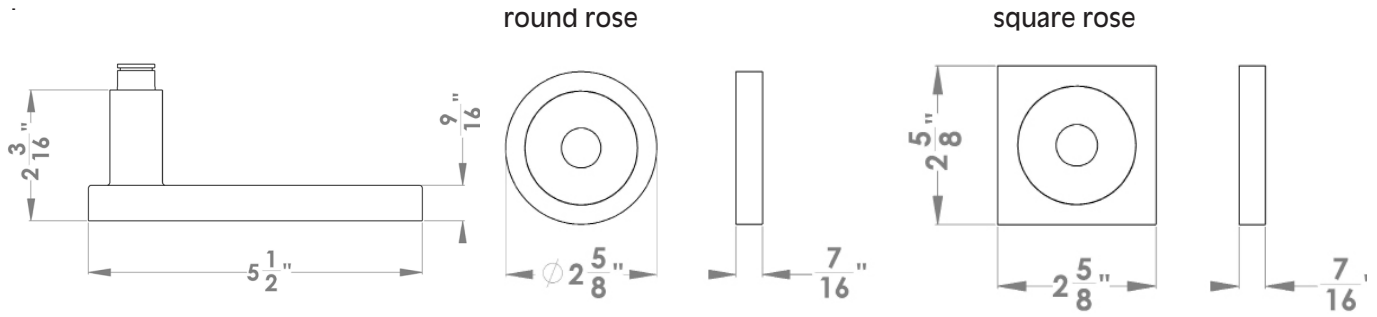

Please note: Karcher Design products are designed and measured in metric. Imperial measurements are close approximations to the actual metric dimensions